



**BETTER HAY STARTS
WITH A MORE PRECISE
CUT AND CONDITION.**

**IT COMES DOWN TO
UNDERSTANDING GRASSES.
FEED VALUE. MOISTURE.
AND YOU.**

TODAY MORE THAN EVER, YOU'RE FACING PRESSURE TO BE SMARTER AND MORE PRODUCTIVE IN EVERYTHING YOU DO—ESPECIALLY WHEN IT COMES TO HAY. AND WHETHER YOU CUT YOUR OWN CROP TWICE A YEAR OR CUSTOM HARVEST 500 ACRES SIX TIMES A SEASON, YOU'VE LEARNED THAT GETTING THE JOB DONE RIGHT STARTS WITH USING THE RIGHT MACHINES.

AT HESSTON BY MASSEY FERGUSON®, WE'VE LEARNED ONE THING FOR CERTAIN: EVERY FARM IS DIFFERENT, SO EVERY FARMER OR RANCHER HAS DIFFERENT NEEDS. THAT'S WHY WE'VE MADE SURE THERE'S A HESSTON® 1300 SERIES DISC MOWER CONDITIONER THAT'S JUST RIGHT FOR YOU, GUARANTEED TO DELIVER SMOOTH CUTTING, MAXIMUM EFFICIENCY AND UNMATCHED RELIABILITY.

IN THE QUEST FOR QUALITY HAY, IT'S ALL ABOUT CONDITIONING.



1947 The Hesston Manufacturing Company was founded in Hesston, Kansas. Today it is part of the Massey Ferguson® family.

1962 Massey Ferguson becomes the world's best-selling tractor brand.

1974 The Hesston 1014 mower conditioner is introduced, the industry's first commercially available center-pivot mower conditioner.

2006 Massey Ferguson and Hesston join forces to produce the new Hesston by Massey Ferguson complete line of hay equipment.

2014 The Hesston 1383 & 1386 are the first ever pull-type mowers to have hydraulic conditioner tension.

2016 Hesston has proudly built high-quality hay equipment for 70 years. Since 1947, Hesston has lead the way with industry-leading innovations like the first self-propelled swather, the first large square baler, the first center-pivot mower conditioner, plus many more. High quality hay is what we do. High quality hay is what we know. Nobody knows hay like Hesston.

2017 We proudly introduce the world's first Ultra High Density Large Square Baler. And continue our lead by creating a baler classification system that allows hay operators to pick the right baler based on their operation.

**CUTTING-EDGE PERFORMANCE
REDEFINES ECONOMY.**



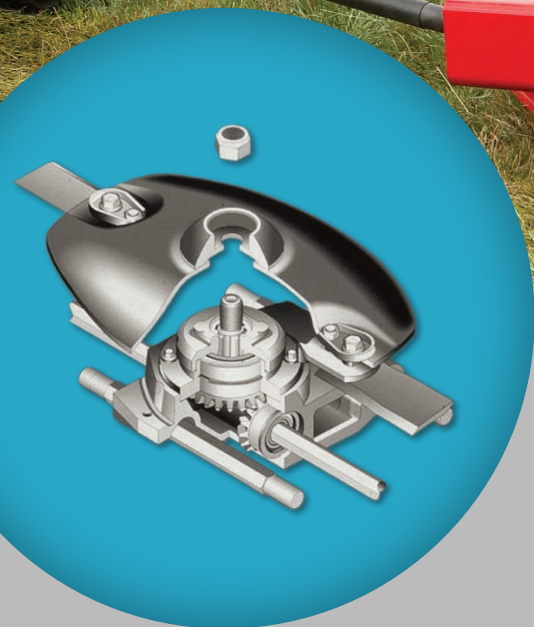

Standard knives feature a 12-degree pitch. For tough conditions like down crop, 18-degree knives are also available for more lift and a cleaner cut.

THE 1359:

IF YOU NEED A VERSATILE, COST-EFFICIENT DISC MOWER CONDITIONER, THE 1359 IS YOUR MACHINE. ITS SEVEN ROTARY DISCS CUT A 9-FOOT, 3-INCH SWATH THROUGH GRASS HAY, PASTURE OR ALFALFA WITH EQUAL EASE. THE RUGGED, SIDE-PULL HITCH EASILY PIVOTS FOR NARROW TRANSPORT. ADD OUR PROVEN HAY CONDITIONER OPTIONS TO MATCH YOUR CROP CONDITIONS, AND YOU HAVE THE PERFECT MACHINE FOR ANY SMALL- TO MID-SIZE OPERATION.



SPRING TENSIONING supports the cutter bar through a variety of field conditions, increasing efficiency and reducing wear.

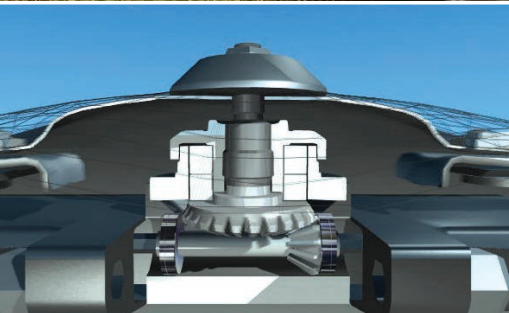

EACH CUTTER BAR is driven by a segmented, reversible hex drive shaft for quick disassembly and reduced operating costs. The hex drive shaft is also designed to absorb the shock of hitting an obstruction, reducing the risk of damage.



RAZOREDGE™ CUTTER BAR REDEFINES DURABILITY.

THE HESSTON 1373 AND 1376

IF YOU'RE LOOKING FOR COMMERCIAL-GRADE SIDE-PULL DISC MOWER CONDITIONERS, LOOK NO FURTHER THAN OUR 1373 AND 1376 MODELS WITH OUR PATENTED RAZOREDGE HEADER. THE MODULAR, HEAVY-DUTY DESIGN MAKES THEM SUPER DURABLE, VIRTUALLY ELIMINATING COSTLY DOWNTIME. NOT ONLY DO THE WIDE-PROFILE TEETH OFFER INCREASED GEAR-TO-GEAR CONTACT, BUT THE ENTIRE DRIVETRAIN IS DESIGNED TO HANDLE MAXIMUM LOAD AT ALL TIMES. AN INDUSTRY EXCLUSIVE, THE RAZOREDGE HEADER'S SEALED BEARINGS DON'T REQUIRE CONSTANT LUBRICATION, NO MATTER THE SLOPE OF THE TERRAIN. SHOULD THE WORST HAPPEN, THE GEAR SPINDLE WILL SHEAR OUTSIDE THE CUTTER BED, KEEPING CONTAMINATION AWAY FROM THE GEARS.

EXCLUSIVE
3-YEAR
RAZORGUARD
WARRANTY



OTHER UNIQUE FEATURES OF THE RAZOREDGE:

- **Adjustable windrow-forming shields** and a swathboard allow you to tailor the windrow size and shape—as narrow as 40 inches—to your baling or harvesting needs.
- **High-carbon steel knives** available in a choice of degrees and bevels to match crop and field conditions.
- **Counter-rotating discs** with increased overlap that provide improved cut quality while minimizing crop streaking.
- **Sloping disc hub** mounts to help reduce debris and twine buildup.
- **Ductile cast iron** conditioner roll gearboxes for maximum durability and power transfer.
- **Bolt on rock guards** to provide replaceable cutterbar protection.
- **Swivel gearbox and support arm** that move with the tongue to keep the driveline components in-line, for exceptionally smooth operation.



THE RAZOREDGE CUTTER BAR'S DESIGN allows each gear assembly and adjacent idler gear to be individually removed without disassembly of the cutter bar. The spur gear design also provides a thinner profile, allowing closer cutting with less scalping.

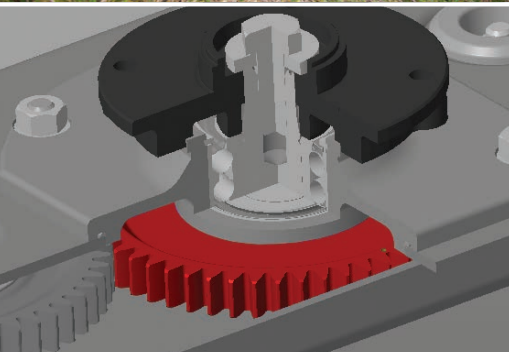

THE INTERNAL SPUR GEARS offer 2.5 teeth contact at all times to transfer high torque and seamless power throughout the entire cutter bar. Gears are forged in house at the AGCO Power Foundry



THE HIGH-CLEARANCE MAINFRAME provides an exceptional header lift height of 20 inches for better clearance over headland windrows. The added height also allows the header to be easily carried over obstacles, ditches and waterways.

A constant-velocity mechanical driveline, coupled with your choice of a three-point or drawbar-mounted swivel hitch, provides smooth power transfer and turn-on-a-dime maneuverability.

DISC MOWER SPEED MEETS CENTER-PIVOT MANEUVERABILITY.



Hydraulic conditioning roll tension on the 1393 & 1316S. This is the first pull-type design to have this system.

THE HESSTON 1393 AND 1316S:

SLICE THROUGH TOUGH, TANGLED CROPS AT SPEEDS THAT CAN ONLY BE ATTAINED WITH A ROTARY DISC MACHINE AND THE MANEUVERABILITY THAT THE HESSTON 1300 SERIES CENTER-PIVOT MODELS CAN PROVIDE. CHOOSE THE HESSTON 1393 WITH ITS 13-FOOT CUTTING WIDTH, OR STEP UP TO THE HESSTON 1316S WITH ITS 16-FOOT CUTTER BED.

Both models feature industry-exclusive hydraulic conditioning roll tension, engineered to deliver consistent quality hay, resulting in a high-nutrient crop that's more palatable and more valuable. A heavy-duty rear arch frame provides exceptional support and header lift of 18 inches for better clearance over headland windrows as well as ditches and waterways. Everything about this rugged, high capacity mower series is designed to give commercial operators reliable, trouble-free performance season after season.

The herringbone steel-on-steel or rubber-on-steel conditioner rolls are powered by individual roll-drive shafts and an oil-lubricated drive gear case that reduces roll drive maintenance.

Add it all up and you've got unmatched reliability coupled with performance that is synonymous with the Hesston by Massey Ferguson name.

PERFORMANCE ALWAYS COMES STANDARD.

NO MATTER WHICH HESSTON 1300 SERIES CENTER-PIVOT DISC MOWER CONDITIONER YOU CHOOSE, YOU CAN BE ASSURED OF QUALITY PERFORMANCE, THANKS TO IMPRESSIVE FEATURES YOU WON'T FIND ON MOST COMPETITIVE MACHINES.

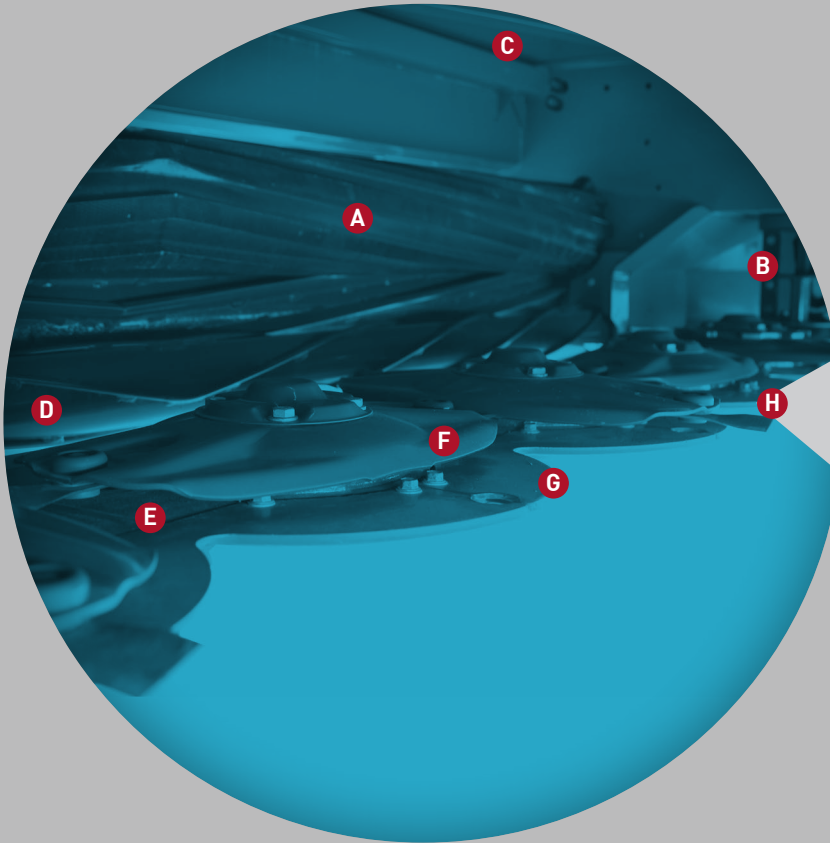

NEW QUICK CHANGE TOOL
This allows you to flip or change out the knives in the field with one simple tool. You just slide the tool into the knife slot, push up and slide out the knife.

- A HERRINGBONE CONDITIONER ROLLS** Extra-wide, 110-inch conditioner rolls increase the capacity of the header and allow the crop to be distributed into a thinner mat for more uniform conditioning.
- B CAGE CROP CONVEYORS** Rotating cages at each end of the cutter bed help convey crop material to the conditioner rolls while preventing crop material from wrapping on the cutter bed driveshaft.
- C TOP SHIELD PROTECTOR** Tough poly panels on the underside of the header shields absorb the impact of rocks and debris to keep the sheet metal from being dented, scraped or exposed to rust.
- D TURBULENCE REDUCTION ROLL** A turbulence reduction roll, or helper roll, located between the conditioner rolls and the cutter bed allows the conditioner rolls to be positioned farther back, improving performance in light crops and assisting crop flow in dense, heavier crops.
- E PRE LUBRICATED, SEALED BEARINGS** Pre lubricated bearings provide a longer life, while substantially reducing maintenance, compared to cutter beds that require regular oil checks.
- F CUTTER BAR** High tooth-to-tooth contact at all times allows the cutter bar to evenly transfer power throughout the cutter bar and helps protect the cutter bar against foreign objects.
- G ROCK GUARDS** Smooth-profile rock guards, integrated into the cutter bed, reduce mud buildup, while protecting the disc and knives from rocks and other obstructions.



CONDITIONER OPTIONS TO MATCH EVERY NEED.

CHOOSE THE CONDITIONER OPTIONS THAT MEET YOUR SPECIFIC CROP AND OPERATING CONDITIONS. REGARDLESS OF MODEL, THE EXTRA-WIDE WIDTH ENSURES THOROUGH, UNIFORM CONDITIONING THAT HELPS INCREASE THE TOTAL VALUE OF YOUR CROP.

MODEL	1359	1373	1376	1393	1316S
RUBBER-ON-STEEL				•	•
STEEL-ON-STEEL	•	•	•	•	•
RUBBER-ON-RUBBER	•	•	•		
TINE CONDITIONER	•	•	•		
LESS CONDITIONER		•	•		



STEEL-ON-STEEL ROLLS Designed to meet the needs of custom and commercial operators, steel-on-steel rolls feature a herringbone pattern that provides long-lasting durability while evenly distributing crop material across the full width of the rolls. They're also the best option for alfalfa, since they crimp the stems, for faster drying while maintaining leaf quality.



RUBBER-ON-STEEL ROLLS These rubber-on-steel conditioner rolls are fully engaged to crimp plant stems along their entire length so stems dry at the same speed as the leaves.

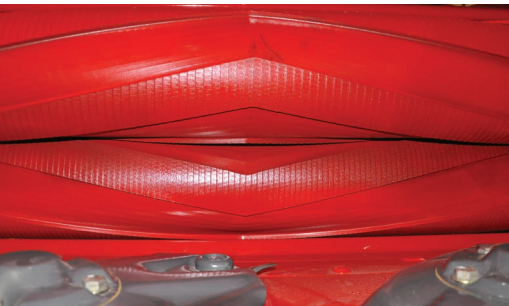

RUBBER-ON-RUBBER ROLLS Featuring a herringbone tread pattern that helps improve windrow formation, our rubber-on-rubber rolls are designed for those who prefer more crushing-type conditioning action. The shallow lugs minimize leaf damage compared to deep-lug urethane rollers that tend to scuff the crop and damage the leaves.



TINE CONDITIONER A good choice for grass hay, the tine conditioner uses tines, spinning at high RPM, to effectively condition the crop and force it to rub against the conditioning panel. This, in turn, scuffs the waxy coating from the plant stems, allowing them to dry faster.



HESSTON 1300 SERIES DISC MOWER CONDITIONERS ARE BUILT TO HANDLE NEARLY ANY TYPE OF MATERIAL OR CHALLENGE, BUT CERTAIN SITUATIONS CALL FOR ADDITIONAL EQUIPMENT. THAT'S WHY WE OFFER ALL THE OPTIONS YOU COULD EVER NEED TO MATCH YOUR SPECIFIC CROPPING PROGRAM. THESE INCLUDE:

- Topping skids and/or skid shoes for additional ground clearance.
- A hydraulic header tilt on select models for on-the-go cutter bar angle adjustment.
- Filler pan kit (1393-1316S only) for enhanced performance in tall-stalk or biomass crops.



INVEST WISELY.

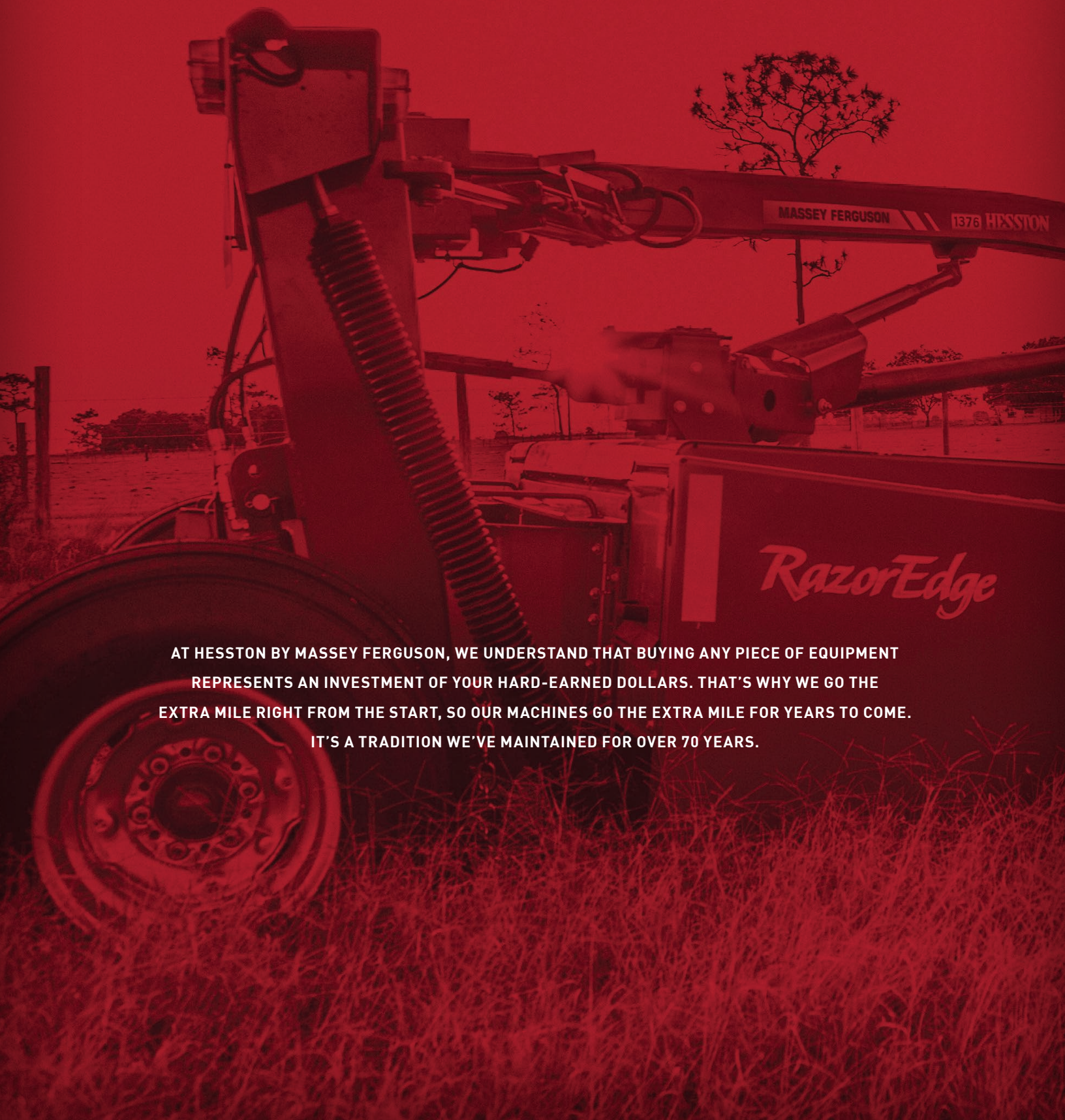

AT HESSTON BY MASSEY FERGUSON, WE UNDERSTAND THAT BUYING ANY PIECE OF EQUIPMENT REPRESENTS AN INVESTMENT OF YOUR HARD-EARNED DOLLARS. THAT'S WHY WE GO THE EXTRA MILE RIGHT FROM THE START, SO OUR MACHINES GO THE EXTRA MILE FOR YEARS TO COME. IT'S A TRADITION WE'VE MAINTAINED FOR OVER 70 YEARS.

A GREAT DEAL INCLUDES A GREAT DEALER.

If you're like most farmers, when you find the perfect piece of equipment, it becomes almost like part of your family. And when you buy a Hesston 1300 Series disc mower conditioner, you instantly become part of ours. Our network of dealers knows what it takes to put up quality hay, and they have the knowledge to match the right mower or mower conditioner with the right producer. They'll advise and support you throughout the selection process, the buying process, through operation, maintenance and beyond. Because our dealers share your passion for farming, they're happy to share their knowledge to keep you working happily and productively. After all, you're family. And there's nothing we wouldn't do for family.

EVEN OUR WARRANTY IS HIGH PERFORMANCE The one-year/unlimited-hour, all-inclusive warranty on parts and labor is one of the best in the business. More importantly, it's backed by dealers who understand how to help you make the most of it.



QUALITY PARTS Genuine AGCO® replacement parts are manufactured to the same high standards of quality and dependability as the original parts used on the assembly line. Using original equipment parts will help keep your mower or mower conditioner running like new for a long time.

**EXCLUSIVE
3-YEAR
RAZORGUARD
WARRANTY**

EXCLUSIVE THREE-YEAR RAZORGUARD WARRANTY Warranty provides an additional two-year parts-only warranty on top of the one-year warranty for the machine. Valid on mowers equipped with RazorEdge heads, including the 1359 model.

LOW-RATE, FLEXIBLE FINANCING Your dealer and AGCO Finance offer attractive financing to make sure a new Hesston 1300 Series disc mower conditioner will fit your operating budget. Extremely competitive rates and terms make it easy to purchase, lease or rent.



The AGCO Farm Life magazine is our exclusive publication that offers farming news, interviews and insights—for and by farmers like you. Visit us online at myfarmlife.com.

HESSTON BY MASSEY FERGUSON 1300 SERIES DISC MOWER CONDITIONER SPECIFICATIONS

BUILD & QUOTE

Easily configure, price and compare equipment using our “Build my Massey Ferguson” tool. You can sort through available product options and design machines to fit your unique needs. Visit masseyferguson.com/buildmymassey

AGCO ANSWERS

At AGCO, customer care isn't just a department. It's a commitment. Contact us with your questions. We'll do our best to answer them promptly, or put you in touch with someone who can.

(877) 525-4384

agcoanswers@agcocorp.com

MERCHANDISE AND GIFTS

shopagco.com See your local Hesston dealer to purchase our collectible WNFR belt buckles.

JOIN OUR CONVERSATION



MODEL		1359	1373
DIMENSIONS AND WEIGHTS			
Width of cut: ft. (m)	9.3 (2.8)	9.8 (3.0)	
Overall width: ft. (m)	11 (3.3)	9.8 (3.0)	
Weight: lbs. (kg.)	3,240 (1,469)	4,520 (2,050)	
MAINFRAME AND HEADER			
Pull/Pivot	Side		
Header lift range: in. (mm)	14 (356)	20 (510)	
Header flotation	Radial and vertical with adjustable springs		
Tires	9.5L x 14SL	11L-15, 31 x 13.5-15 (Opt.)	
CUTTER BED			
Cutter bar design	Modular component shaft drive	Spur gear—RazorEdge	
Cutting height: in. (mm)	1.8 to 3.0 (44 to 76)	1.25 to 3 (32 to 76)	
Cutter bar operating range	0° to 8°	0° to 6°	
Number of discs	7	6	
Number of knives	14 (2 per disc)	12 (2 per disc)	
Drive	Hex shaft from gearbox	3B powerband/gearbox	
Disc speed: RPM	3,000	2,200	
Knife tip speed: mph (km. / hr.)	175.8 (289)	162 (260.7)	
Knives	Swing-away, reversible		
CONDITIONER			
Roll type	Steel-on-steel or tine conditioner	Herringbone steel-on-steel, Tine conditioner	
Length: in. (mm)	84 (2,134)	73 (1,854)	
Speed: RPM	735	1,045	
Drive	U-joint drivelines from gearbox		
DIAMETER			
Upr. Rubber-on-Steel roll: in. (mm)	NA	NA	
Upr./Lwr. Steel-on-Steel roll: in. (mm)	9.3 (235)	8.2 (209)	
Rubber-on-Rubber roll: in. (mm)	9.5 (242)	8.0 (203)	
Roll Speed: RPM	735	1,045	
Less conditioner	NA	Opt.	
Tine conditioner	NA	Opt.	
Tine conditioner diameter: in. (mm)	18 (462)	18 (462)	
Number of double tines	40	40	
Tine speed: RPM	1,056	1,056	
WINDROW WIDTH			
Windrow formation max.: in. (mm)	72 (1,829)	73 (1,854)	
Windrow formation min.: in. (mm)	30 (762)	42 (1,067)	
TRACTOR REQUIREMENTS			
Min. PTO: horsepower (kW)	60 (45)	75 (56)	
PTO speed	540		
Hydraulics	1 DAV; 1 SAV		



MODEL	1376	1393	1316S
DIMENSIONS AND WEIGHTS			
Width of cut: ft. (m)	9.8 [3.0]	13 [3.9]	16 [4.8]
Overall width: ft. (m)	9.8 [3.0]	13.25 [4]	16.25 [4.9]
Weight: lbs. (kg.)	5,050 [2,291]	6,660 [3,020]	8,150 [3,697]
MAINFRAME AND HEADER			
Pull/Pivot	Center		
Header lift range: in. (mm)	20 [510]	18 [457]	
Header flotation	Radial and vertical with adjustable springs		
Tires	11L-15, 31 x 13.5-15 (Opt.)	31 x 13.5 x 15	
CUTTER BED			
Cutter bar design	Spur gear—RazorEdge		
Cutting height: in. (mm)	1.25 to 3 [32 to 76]		
Cutter bar operating range	0° to 6°		
Number of discs	6	8	10
Number of knives	12 [2 per disc]	16 [2 per disc]	20 [2 per disc]
Drive	3B powerband/gearbox	2B banded belt	
Disc speed: RPM	2,200	2,450	
Knife tip speed: mph (km. / hr.)	163 [260.7]	178 [287]	
Knives	Swing-away, reversible		
CONDITIONER			
Roll type	Herringbone steel-on-steel, Tine conditioner	Herringbone steel-on-steel or rubber-on-steel	
Length: in. (mm)	73 [1,854]	109.8 [2,790]	
Speed: RPM	1,045	1,037	1,215
Drive	U-joint drivelines from gearbox		
DIAMETER			
Upr. Rubber-on-Steel roll: in. (mm)	NA	8 [203]	
Upr./Lwr. Steel-on-Steel roll: in. (mm)	8.2 [209]	7.7 [196]	
Rubber-on-Rubber roll: in. (mm)	8.0 [203]	NA	
Roll Speed: RPM	1,045	1,037	1,215
Less conditioner	Opt.	NA	
Tine conditioner	Opt.	NA	
Tine conditioner diameter: in. (mm)	18 [462]	NA	
Number of double tines	40	NA	
Tine speed: RPM	1,056	NA	
WINDROW WIDTH			
Windrow formation max.: in. (mm)	73 [1,854]	96 [2,438]	
Windrow formation min.: in. (mm)	42 [1,067]	40 [1,016]	
TRACTOR REQUIREMENTS			
Min. PTO: horsepower (kW)	75 [56]	100 [75]	120 [89]
PTO speed	540	1,000	
Hydraulics	1 DAV; 1 SAV	2 DAV	



FOR MORE THAN 25 YEARS, IN MORE THAN 140 COUNTRIES WORLDWIDE, AGCO HAS BEEN ON A MISSION TO BECOME THE SINGLE RESOURCE FARMERS CAN DEPEND ON FOR INNOVATIVE, LEADING-EDGE THINKING, EQUIPMENT AND TECHNOLOGY. AND, TODAY, YOU KNOW AGCO BRANDS, EVEN IF YOU DON'T KNOW THE AGCO NAME. WHILE AGCO EQUIPMENT MAY NOT ALL SHARE THE SAME LOGO OR SAME COLOR, THEY ALL HAVE ONE THING IN COMMON—THE ABILITY TO HELP FARMERS BE AS PRODUCTIVE AND PROFITABLE AS THEY CAN POSSIBLY BE, REGARDLESS OF THE TASKS AT HAND. agcocorp.com